



Caxtool Kft.  
6791 Szeged, Dorozsmai út 157. EU  
+36 62 254 826  
+36 30 565 1812  
[d.zanocz@caxtool.hu](mailto:d.zanocz@caxtool.hu)  
[info@caxtool.hu](mailto:info@caxtool.hu)

Adószám: 12871856-2-06  
Adószám: HU 12871856  
Bankszámla száma: 57600101-11102986  
SWIFT (BIC): TAKBHUHB  
IBAN: HU65 57600101 11102986 00000000  
cégjegyzékszám: 06-09-014002  
info:

## Képgyűjtemény

### Fiber lézervágó berendezés

**CAXTC\_LM\_3015\_2kW\_J\_1.0 fiber lézervágó berendezés / Fiber cutting machine**





Caxtool Kft.  
6791 Szeged, Dorozsmai út 157. EU  
+36 62 254 826  
+36 30 565 1812  
[d.zanocz@caxtool.hu](mailto:d.zanocz@caxtool.hu)  
[info@caxtool.hu](mailto:info@caxtool.hu)

Adószám: 12871856-2-06  
Adószám: HU 12871856  
Bankszámla száma: 57600101-11102986  
SWIFT (BIC): TAKBHUHB  
IBAN: HU65 57600101 11102986 00000000  
cégjegyzékszám: 06-09-014002  
info:

- **Machine Application**

Widely used in sheetmetal processing, aviation, aerospace, electronics, electrical appliances, automobile, food machinery, textile machinery, engineering machinery, precision parts, ships, metallurgy equipment, elevators, household appliances, craft gifts, tool processing, decoration, advertising, and other fields. Professional used to cut sheet metal like carbon/mildsteel, stainless steel, aluminum alloy, galvanized sheet, electrolytic plate, titanium alloy, aluminum zinc plate, etc.

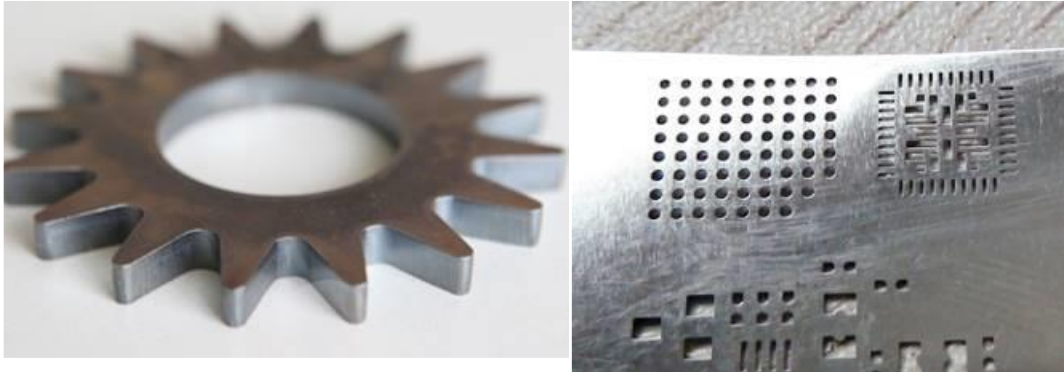

- **Lézer rezonátor / JPTCW 2000 Fiber Laser (2000W)**

JPT single mode fiber laser(500W-2000W) is the optimal combination of optical, mechanical, electrical and software components. Through the controlling ports and the controlling software, the operating status of the laser can be monitored in real time, alarm messages can be received in time, and data can be collected. The laser uses water-cooling and shelf case design, with competitive advantage like high energy conversion (electric to light), low power consumption, maintenance free, fiber delivery, and easy to assemble, it is the most suitable laser source for industrial laser welding, cutting and other applications.



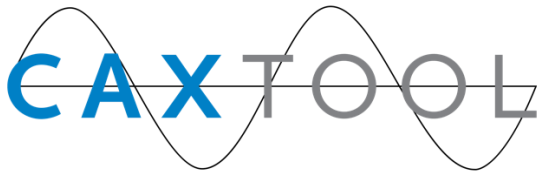

Caxtool Kft.  
 6791 Szeged, Dorozsmai út 157. EU  
 +36 62 254 826  
 +36 30 565 1812  
[d.zanocz@caxtool.hu](mailto:d.zanocz@caxtool.hu)  
[info@caxtool.hu](mailto:info@caxtool.hu)

Adószám: 12871856-2-06  
 Adószám: HU 12871856  
 Bankszámla száma: 57600101-11102986  
 SWIFT (BIC): TAKBHUHB  
 IBAN: HU65 57600101 11102986 00000000  
 cégjegyzékszám: 06-09-014002  
 info:

	Unit	Parameter				
Nominal Average Output Power	W	500	800	1000	1500	2000
Beam Parameter Product	mm*mrad	<2 @50um				
Central Wavelength	nm	1080				
Spectral Width@3db	nm	<6				
Armored Cable Length	M	8			15	
Cooling Method		Water Cooled (Purified Water)				
Operating Voltage	V	Single-phase 220(AC)±10%			Three-phase 380(AC)±10%	
Maximum Power Consumption	W	1800	2700	3300	5000	7000
Switch on/off time	us	<20				
Maximum Modulation Frequency	khz	20				
Operation Temperature	°C	23 ~ 26				
Storage Temperature	°C	-20 ~50				
N.W	kg	36			83.5	
Size (WxDxH)	mm	483 × 484 × 133			483 × 800 × 178	

### **RayTools BM111 (Auto Focus) laser head**

•The RAYTOOLS AG comes with the external motor and the built-in drive unit through the linear driver and the focusing lens can automatically change the position in the range of 25mm. The user can set the focus continuously through the program to complete the rapidpiercing of thick sheets or other different thickness and material sheets.

- 35mm clear aperture, effectively reducing stray light interference, guarantee cutting quality and service life ;
- Motorized adjustment of lens position
- Anticollision system included
- Contains adjust box EG 8030, focal lens 200mm, glass protection, 3 nozzles.
- Cutting head contains collimator at 90° focal 100mm
- With a variety of optical interfaces, can be adapted with a variety of fiberlasers.
- Compact design
- Motorized protection windows
- Auto focus ranges +10~-12mm, accuracy is 0.05mm
- Drawer-type of lens mount, quick and easy access to the cover glass.
- Automatic adjustment of the focus and depth of the laser beam by "MZ -collimator module.

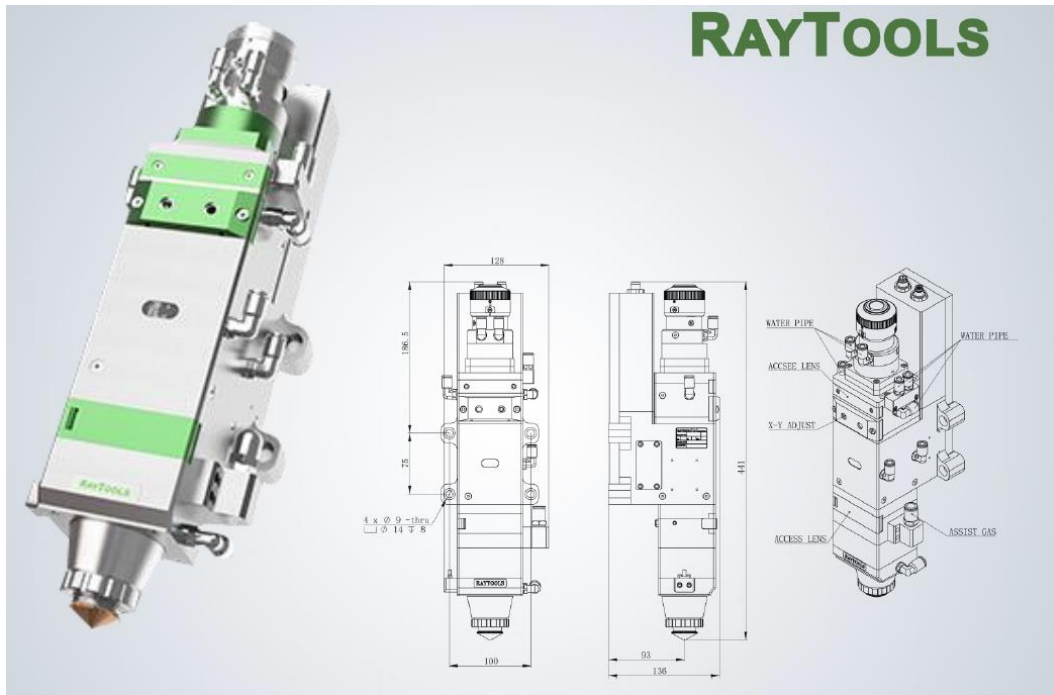

- **Cooling System S&A CWFL-2000**

S&A brand CWFL-2000 water chiller is specially applied to cool the fiber laser and optic lenses at the same time, multiple use for saving cost, space and manual move, quite convenient for the user.

S&A industrial water chiller has 2 temperature control modes as constant temperature and intelligent temperature control. Under intelligent mode, the water temperature is adjusted according to ambient temperature. You do not need to worry about the water temperature adjustment of seasonal changes.



- ✓ FIBER LASER CHILLER
- ✓  $\pm 0.5^{\circ}\text{C}$







Caxtool Kft.  
6791 Szeged, Dorozsmai út 157. EU  
+36 62 254 826  
+36 30 565 1812  
[d.zanocz@caxtool.hu](mailto:d.zanocz@caxtool.hu)  
[info@caxtool.hu](mailto:info@caxtool.hu)

Adószám: 12871856-2-06  
Adószám: HU 12871856  
Bankszámla száma: 57600101-11102986  
SWIFT (BIC): TAKBHUHB  
IBAN: HU65 57600101 11102986 00000000  
cégjegyzékszám: 06-09-014002  
info:

- **CNC Control System FSCUT2000C and Software CypCut**



**FSCUT2000C** laser cutting control system and its **CypCut** software integrates file reading, design, output, and processing control. It's able to complete the entire process from design to processing. The software, installed in an industrial computer, provides a wealth of laser cutting processing parameters, flexible layout and cutting path editing capabilities. CypCut Control system and software in English language, supporting files: DXF, PLT, AI, LXD, etc. Drawing in the software is possible. Software is with fly cutting mode for cutting same products to save time. The nesting function automatically arranges graphs to leave minimum spaces and save materials.

## Transmission System



Machine is with Taiwan YYC gear rack and PMI linear rail transmission, which ensures machine high speed movement, precision and stability as well.

- **Lineáris rendszer meghajtása / Driving system**
- **YASKAWA brand servo motors and drivers.** Machine X is driven by a 1300W motor, Y is driven by two 1300W motors, and Z (laser head auto focusing) is driven by a 400W motor.





Az alkalmazott servo motorok Schneider servo motors and drivers. X, Y1, Y2: Schneider 1000W. Z: Schneider 400W. Motor reducer is SHIMPO.

- **Auto Lubrication**

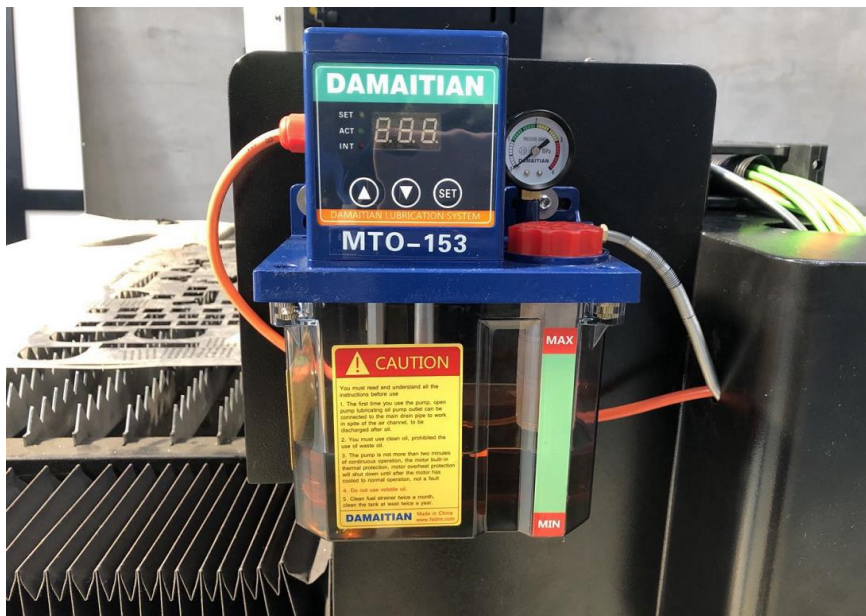

It automatically lubricates guide rails, which ensures the machine keep moving smoothly and with good precision.

- **Exhaust System**



A 2.2Kw centrifugal exhaust fan strongly removes the fumes and dusts caused during cutting.

- **Gas Assist Valves (Solenoid Valve, SMC Proportional Valve)**







Caxtool Kft.  
6791 Szeged, Dorozsmai út 157. EU  
+36 62 254 826  
+36 30 565 1812  
[d.zanocz@caxtool.hu](mailto:d.zanocz@caxtool.hu)  
[info@caxtool.hu](mailto:info@caxtool.hu)

Adószám: 12871856-2-06  
Adószám: HU 12871856  
Bankszámla száma: 57600101-11102986  
SWIFT (BIC): TAKBHUHB  
IBAN: HU65 57600101 11102986 00000000  
cégjegyzékszám: 06-09-014002  
info:

Gas assists cutting either in cutting speed, cutting thickness or cutting effect.

For example, oxygen helps to cut faster and thicker; nitrogen helps to get brighter cutting edge.

The solenoid valve controls the gas blowing. Gas blows only during cutting, which saves your gas cost. SMC proportional valve controls the gas pressure and brings good cutting all the time, for example, gas pressure is lowered when cutting corners.

- **Machine Body**



- **Machine Table**

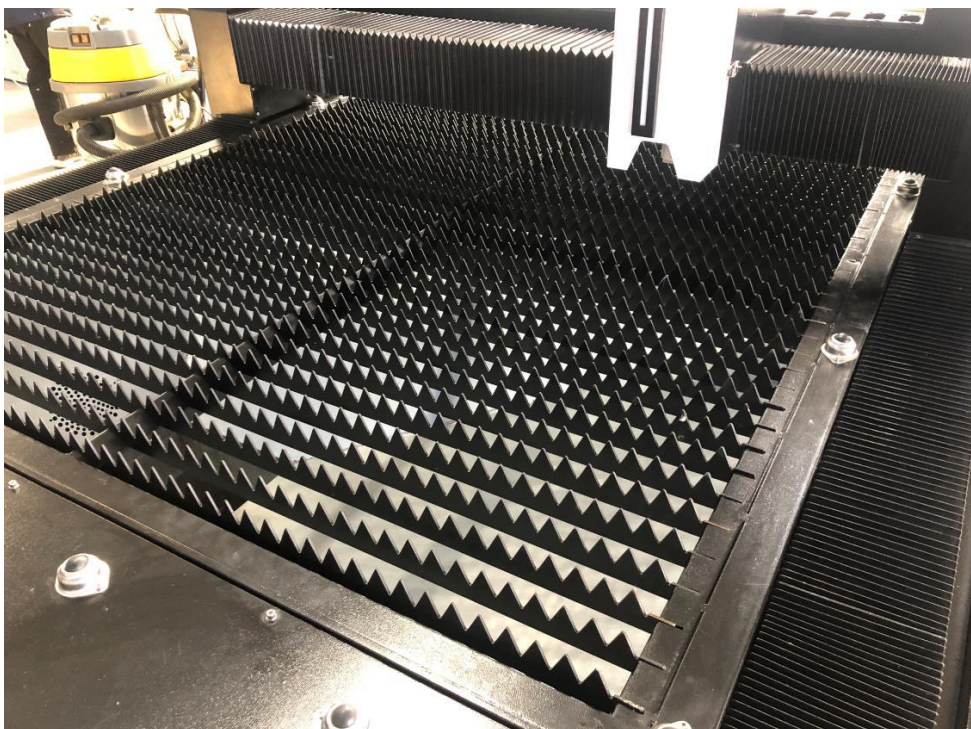

Saw-shape machine table holds metal sheet steady with little touch with metal sheet. The saws are thick and durable. Machine table size is 1500mm by3000mm.

- **Ipari szűrő (opció) / Extractor (Option)**

- The fumes extraction or aspiration system for the treatment of vapors and fumes derived from laser cutting, consisting of:
- Filter plates with automatic compressed air cleaning cycle Integrated silencer
- Elimination of dust, particles and harmful fumes generated during cutting:
- Self cleaning and Easy Disposal
- Free contacts for external control
- Integrated fan
- Dust load dependent automatic filter cleaning
- This system is used to filter dry dust from industrial leaks, in accordance with VDI guidelines 3677, paragraph 4. The filter elements use compact porous filters.
- In many countries it is forbidden to circulate filtered air during the cutting of stainless steel (CrNi). Therefore, it is recommended that the user install air ducts to the outside.





Caxtool Kft.  
6791 Szeged, Dorozsmai út 157. EU  
+36 62 254 826  
+36 30 565 1812  
[d.zanocz@caxtool.hu](mailto:d.zanocz@caxtool.hu)  
[info@caxtool.hu](mailto:info@caxtool.hu)

Adószám: 12871856-2-06  
Adószám: HU 12871856  
Bankszámla száma: 57600101-11102986  
SWIFT (BIC): TAKBHUHB  
IBAN: HU65 57600101 11102986 00000000  
cégjegyzékszám: 06-09-014002  
info:

- **Full cover with CE security glass (option)**



In front door, the glass is CE security glass. Machine left and right side, they are normal glasses.







Caxtool Kft.  
6791 Szeged, Dorozsmai út 157. EU  
+36 62 254 826  
+36 30 565 1812  
[d.zanocz@caxtool.hu](mailto:d.zanocz@caxtool.hu)  
[info@caxtool.hu](mailto:info@caxtool.hu)

Adószám: 12871856-2-06  
Adószám: HU 12871856  
Bankszámla száma: 57600101-11102986  
SWIFT (BIC): TAKBHUHB  
IBAN: HU65 57600101 11102986 00000000  
cégjegyzékszám: 06-09-014002  
info:

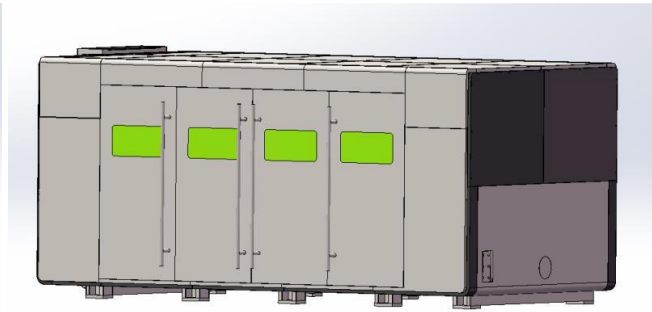
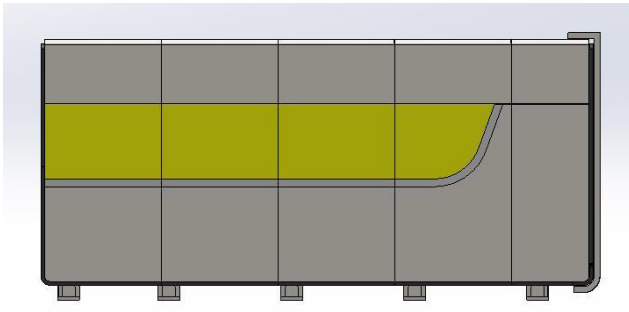

- **Material Loading System**

The machine has folding doors at right side, through which you can load the metal sheets to the machine table. For easier loading of metal sheet, we build the machine with nylon shaft besides the machine table. The shaft is higher than the machine table and Y-axis movement structure, so the metal sheet won't be blocked. Nylon shaft (instead of metal shaft) will not scratch the metal sheet.

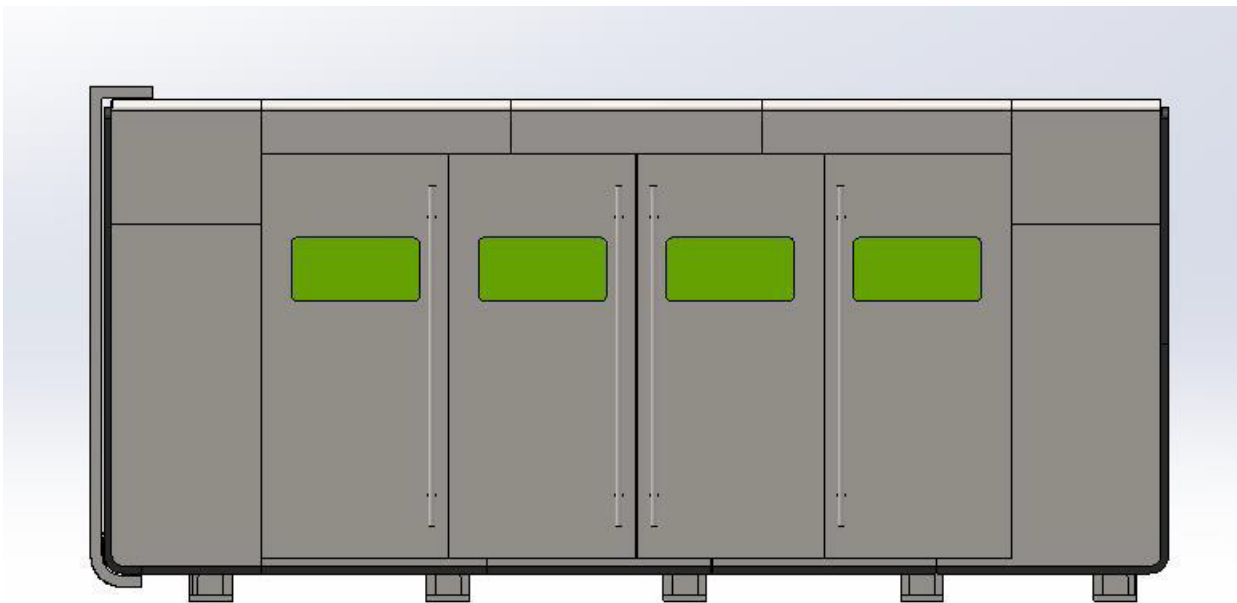



Caxtool Kft.  
6791 Szeged, Dorozsmai út 157. EU  
+36 62 254 826  
+36 30 565 1812  
[d.zanocz@caxtool.hu](mailto:d.zanocz@caxtool.hu)  
[info@caxtool.hu](mailto:info@caxtool.hu)

Adószám: 12871856-2-06  
Adószám: HU 12871856  
Bankszámla száma: 57600101-11102986  
SWIFT (BIC): TAKBHUHB  
IBAN: HU65 57600101 11102986 00000000  
cégjegyzékszám: 06-09-014002  
info:

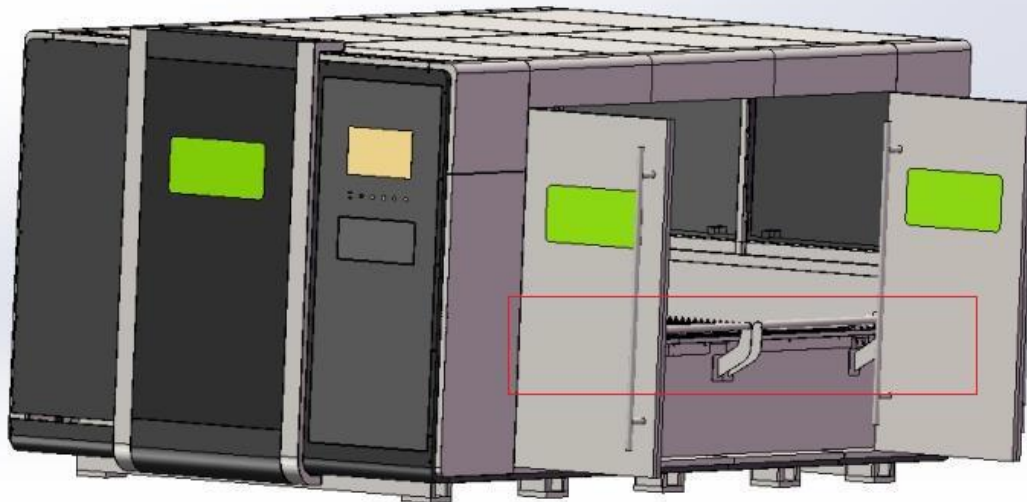
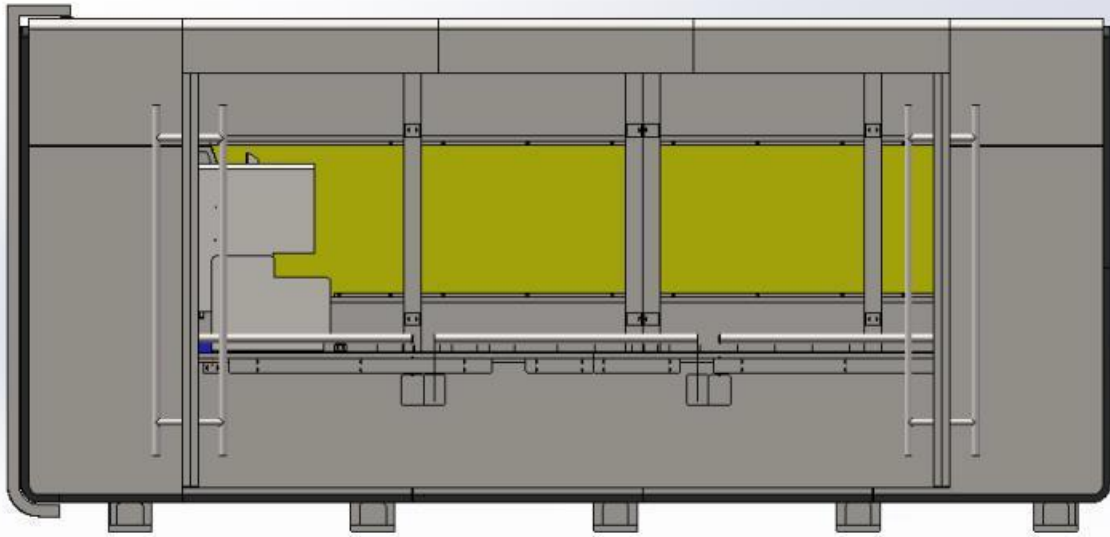

Nylon shaft assisting metal sheet loading

- Safety goggles

